

## Size 1\* Square Body High Speed Traction Fuse Links for Third Rail Applications 20A to 215A 1200Vdc

Catalogue Symbol: 170M2100 to 170M2111

Class of Operation: aR

Fuse Size: Size 1\*

Standards/Approvals: IEC 60269

Microswitch (optional): 170H0069 Type K indicator, 6.3 x 0.8mm lugs. 1.5V operating voltage.



Description: A range of square body high speed traction fuse links for superior protection of DC third rail applications up to 1200Vdc

Packaging: MOQ: 1  
Packaging 100% recyclable

Technical Data:  
Rated Voltage: 1200Vdc  
Rated Current/Mounting Method: 20-215A, Size 1\*, Single Slot Tag  
Tested Breaking Capacity: 50kA at 1350Vdc, L/R 12ms

### Dimensions - mm

170M2100 to 170M2111 - Single Slot Tag - Size 1\* - 20 to 215A

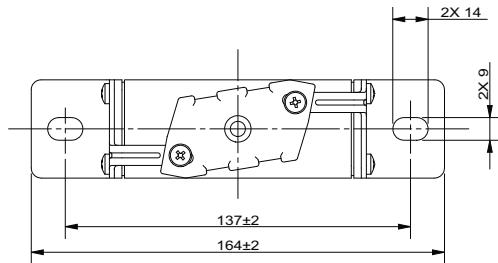
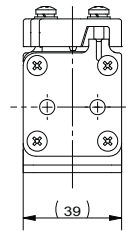
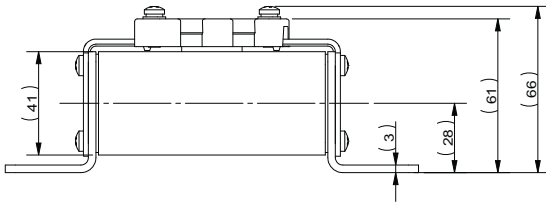

### Technical Data

| Part Number | Fuse Link Type  | Fuse Link Size | Rated Voltage (Vdc) | Rated Current (Amps) | Energy Integrals I <sup>2</sup> t (A <sup>2</sup> s) |                  | Watts Loss (W)     |                |
|-------------|-----------------|----------------|---------------------|----------------------|--|------------------|--------------------|----------------|
|             |                 |                |                     |                      | Pre-Arcing   | Total at 1200Vdc | 0.8 I <sub>n</sub> | I <sub>n</sub> |
| 170M2100    | Single Slot Tag | 1*             | 1200                | 20                   | 82   | 249              | 1                  | 2              |
| 170M2101    |                 |                |                     | 25                   | 173  | 526              | 4                  | 8              |
| 170M2102    |                 |                |                     | 32                   | 327  | 994              | 5                  | 9              |
| 170M2103    |                 |                |                     | 40                   | 550  | 1675             | 1                  | 9              |
| 170M2104    |                 |                |                     | 50                   | 950  | 2890             | 7                  | 13             |
| 170M2105    |                 |                |                     | 63                   | 1310   | 3990             | 5                  | 9              |
| 170M2106    |                 |                |                     | 80                   | 1970   | 6000             | 13                 | 23             |
| 170M2107    |                 |                |                     | 100                  | 3800   | 11,600           | 14                 | 26             |
| 170M2108    |                 |                |                     | 125                  | 8550   | 26,025           | 13                 | 24             |
| 170M2109    |                 |                |                     | 160                  | 8770   | 26,700           | 24                 | 44             |
| 170M2110    |                 |                |                     | 200                  | 15,200   | 46,300           | 29                 | 52             |
| 170M2111    |                 |                |                     | 215                  | 16,430   | 50,000           | 32                 | 58             |

1\* = Size 1 Compact Size

**Size 1\* Square Body High Speed Traction Fuse Links for Third Rail Applications  
20A to 215A 1200Vdc**

**Time-Current Characteristics  
170M2100 to 170M2111, 20 to 215A, Single Slot Tag, Size 1\***

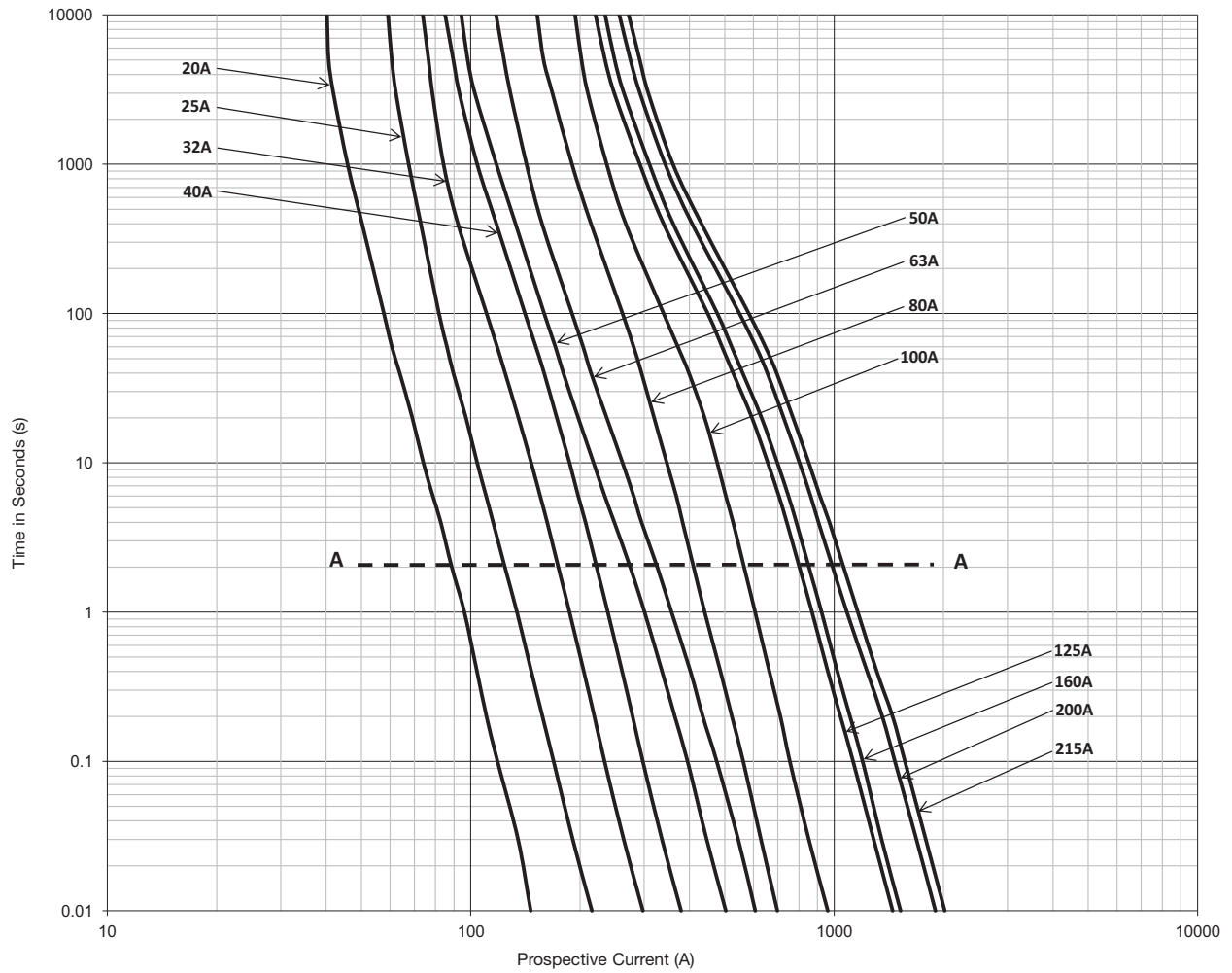

1\* = Size 1 Compact Size